

# Installation Manual

FORD EDGE 5DR  
FOR-EDGE-5-A-18



COMPONENTS INCLUDED

FIXING CLIPS



CL-M12 x 4



# Side Shade Installation

FORD EDGE 5DR  
FOR-EDGE-5-A-18

## COMPONENTS NEEDED:



### STEP #1

ATTACH CLIPS ON SHADE EDGES



### STEP #2

POSITION THE SIDE SHADE



### STEP #3

INSERT CLIPS INSIDE WEATHERSTRIP

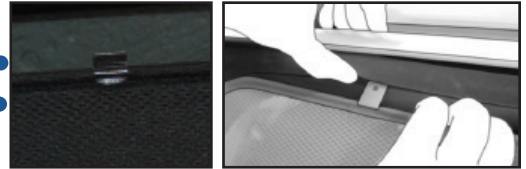

### STEP #4

ENSURE SECURELY FITTED IN PLACE

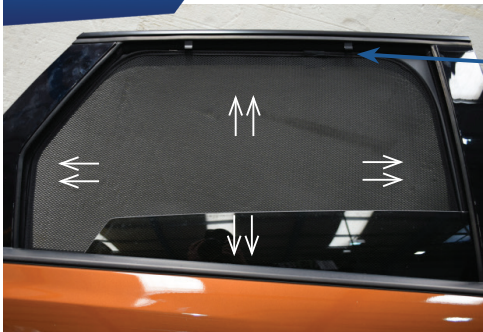

**CAR**  
SHADES