

Installation Manual

HYUNDAI I10 5DR
HYU-I10-5-B-18



COMPONENTS INCLUDED

FIXING CLIPS



CL-M02 x 4



CL-M03 x 2



Side Shade Installation

HYUNDAI I10 5DR

HYU-I10-5-B-18

COMPONENTS NEEDED:



STEP #1

ATTACH CLIPS ON SHADE EDGES

CL-M02



STEP #2

POSITION THE SIDE SHADE



STEP #3

INSERT CLIPS INSIDE WEATHERSTRIP

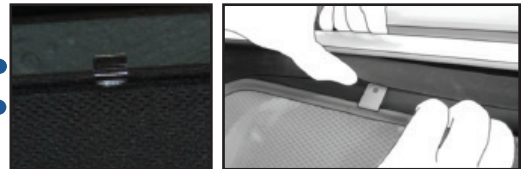

STEP #4

ENSURE SECURELY FITTED IN PLACE

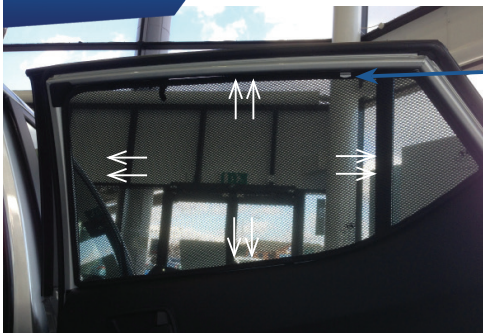

CAR
SHADES