

Installation Manual

JEEP RENEGADE 5DR
JEE-RENE-5-A-18



COMPONENTS INCLUDED



FIXING CLIPS



CL-M05 x 2



CL-M02 x 2



CL-T01 x 1



Side Shade Installation

JEEP RENEGADE 5DR
JEE-RENE-5-A-18

COMPONENTS NEEDED:



STEP #1

INSERT M05 CLIP INTO POSITION
CIRCLED



STEP #2

PEEL BACK THE RUBBER STRIP USING
THE TOOL



STEP #3

INSERT THE M05 CLIP AND PUT THE
RUBBER STRIP BACK INTO POSITION



STEP #4

THIS IS WHAT IT WILL LOOK LIKE
ONCE IN POSITION



STEP #5

ATTACH CLIPS ON SHADE EDGES



CAR[®]
S H A D E S

Side Shade Installation

JEEP RENEGADE 5DR
JEE-RENE-5-A-18

STEP #6

POSITION THE SIDE SHADE

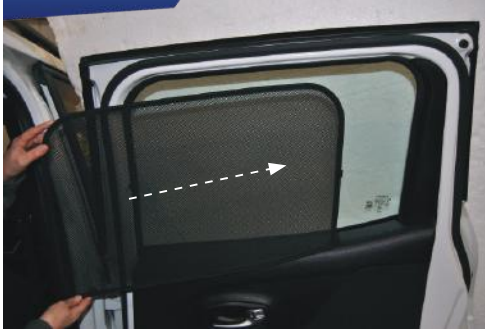

STEP #7

ATTACH SIDE SHADE BEHIND CLIPS



STEP #8

ENSURE SECURELY FITTED IN PLACE



CAR[®]
S H A D E S