

Installation Manual

NISSAN X-TRAIL
NIS-XTRL-5-C-18



COMPONENTS INCLUDED

FIXING CLIPS



CL-M02 x 4



Side Shade Installation

NISSAN X-TRAIL
NIS-XTRL-5-C-18

COMPONENTS NEEDED:

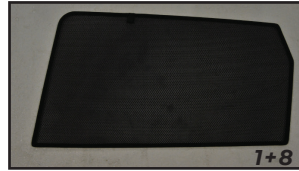

STEP #1

ATTACH CLIPS ON SHADE EDGES

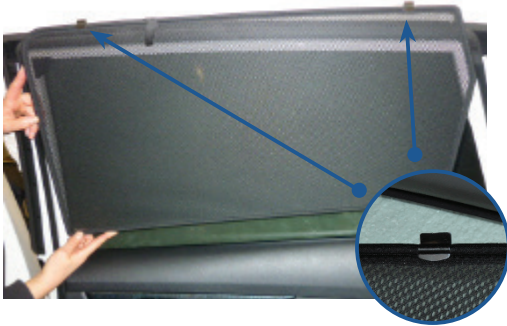

STEP #2

POSITION THE SIDE SHADE

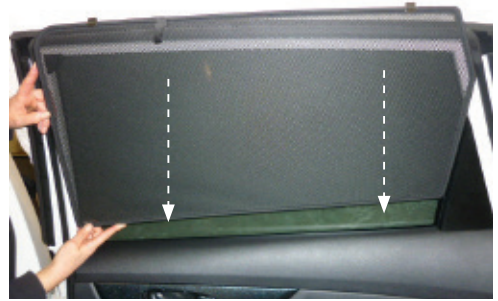

STEP #3

INSERT CLIPS INSIDE WEATHERSTRIP

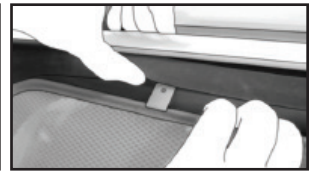
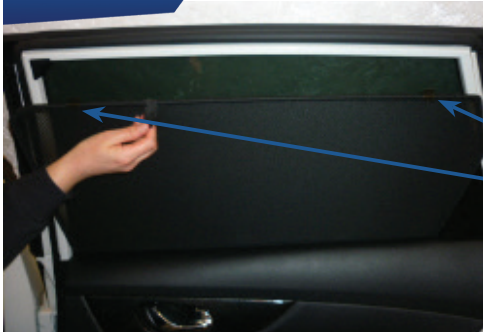

STEP #4

ENSURE SECURELY FITTED IN PLACE

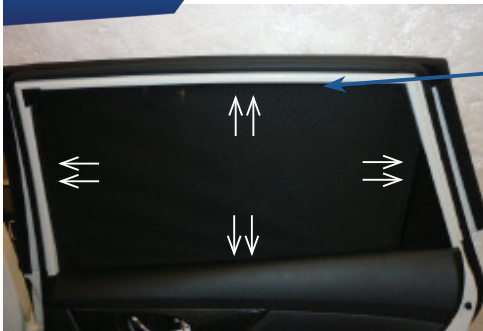

CAR
SHADES