

Installation Manual

VOLVO V90 EST
VOL-V90-E-A-18



Shades



x 2

Fixing Clips



CL-M13 x 2



CL-M12 x 2



CL-M02 x 4



Side Shade Installation

VOLVO V90 EST
VOL-V90-E-A-18

COMPONENTS NEEDED:



STEP #1

ATTACH CLIPS ON SHADE EDGES

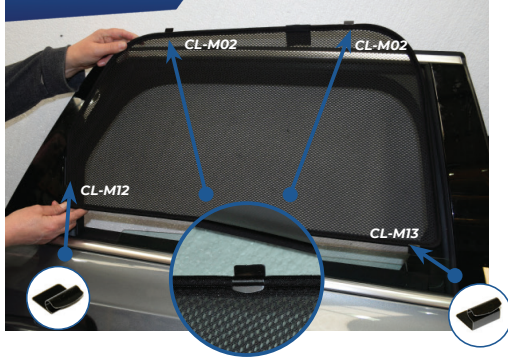

STEP #2

POSITION THE SIDE SHADE

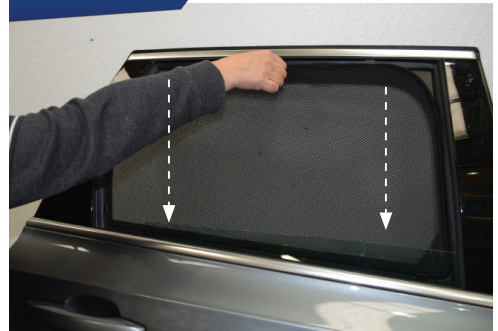

STEP #3

INSERT CLIPS INSIDE WEATHERSTRIP

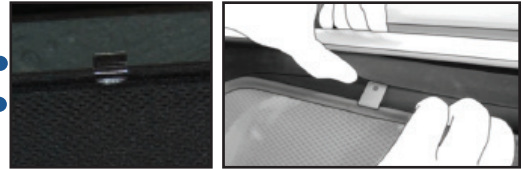
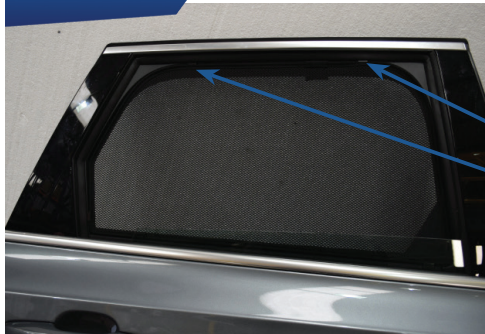

STEP #4

ENSURE SECURELY FITTED IN PLACE

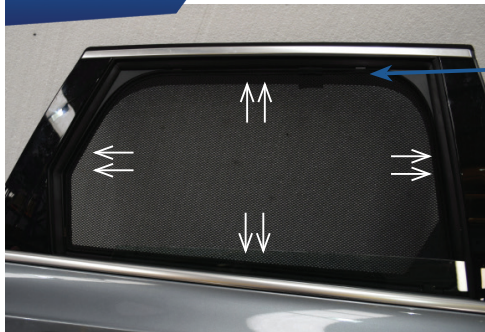

CAR
SHADES