

41.0311 - Smart-Link (for Smart-Step) - Refer to compatibility list

41.4629 - Smart-Link (for Smart-Step) - Compatibel with Renault/Opel

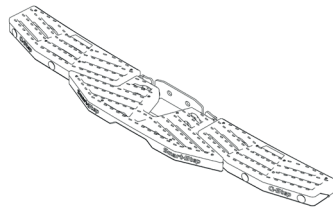

1x - Smart-Step  
41.0309 - Smart-Step pro  
41.0313 - Smart-Step

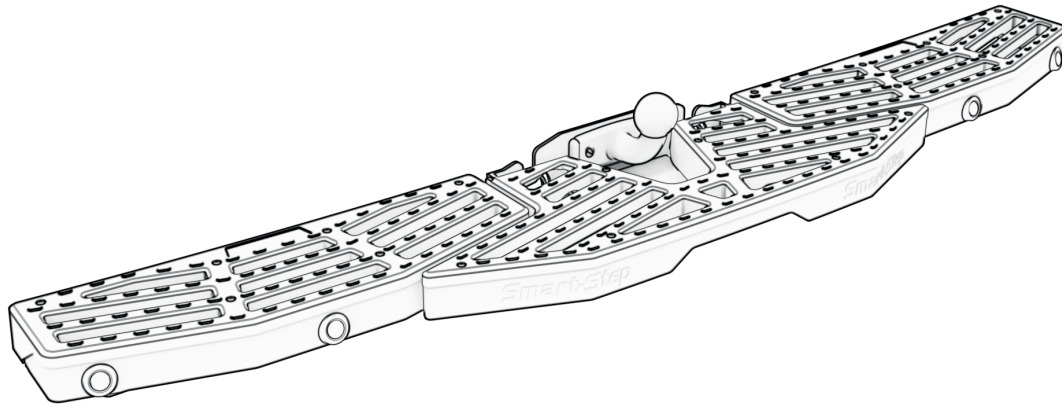
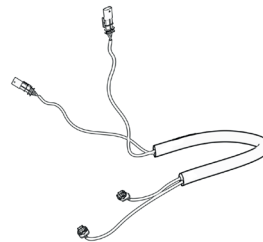

1x - Smart-Link  
41.4633 - Renault-Opel-Nissan-Maxus  
or  
41.4631 - Other vehicles

4x

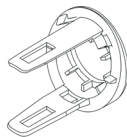

PDC Retainer  
41.4627

4x



Insert cap  
41.4663

12x



Push mount zip tie  
41.4623

4x



Zip tie 300x4.8mm  
20.0363

4x



Zip tie 100x2.5mm  
20.0359

Carefully checked by: \_\_\_\_\_

Packaging Date: \_\_\_\_\_

17 - M10  
T43 Nm

24 - M16  
T270 Nm



Aan alle technische tekeningen kunnen geen rechten worden ontleend, maatvoering kan afwijken van de realiteit.  
No rights can be derived from these technical drawings, sizes may differ from reality.  
Aucuns droits ne peuvent être dérivés de tous les dessins, dimensions peuvent différer de la réalité.  
Alle technischen Zeichnungen können keine Rechte abgeleitet werden, Abmessungen können von der Realität abweichen.

Manual nr: A-01

1 Remove sensors out of the bumper

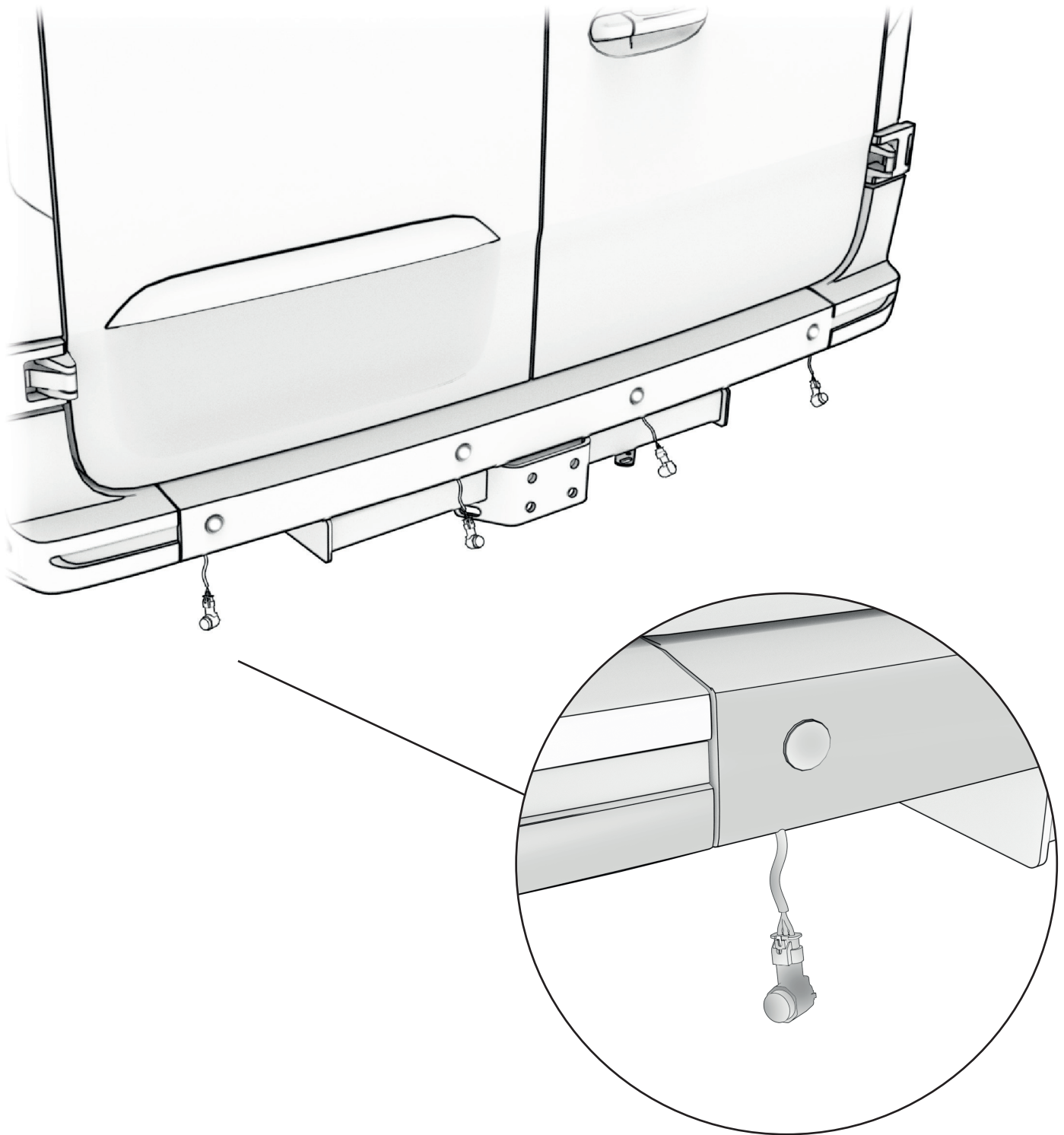

2 Mark sensor with their position

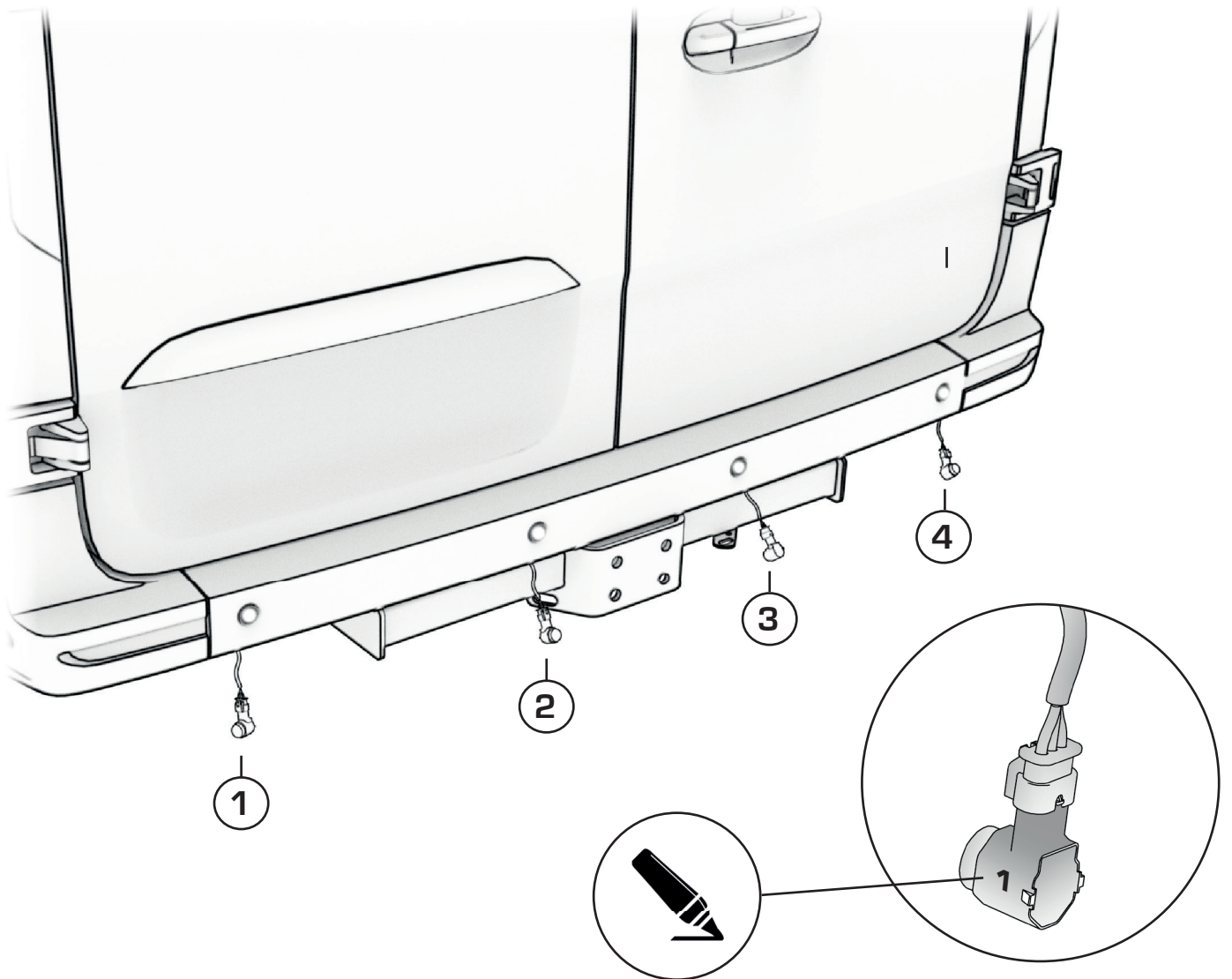

3 Disconnect sensors from connectors

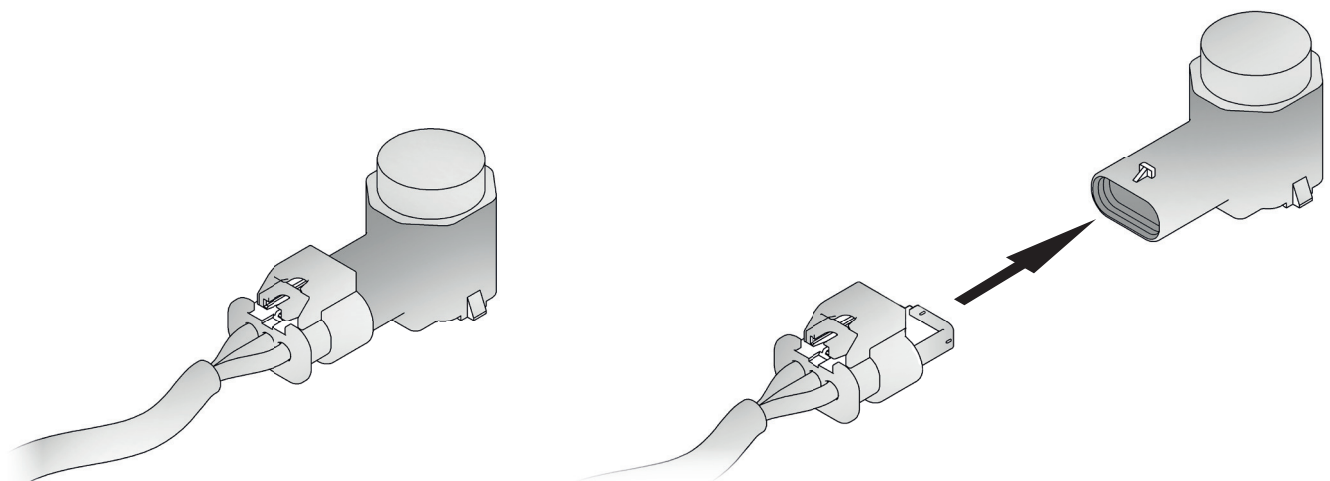

4

Connect the Smart-Link cable to the car

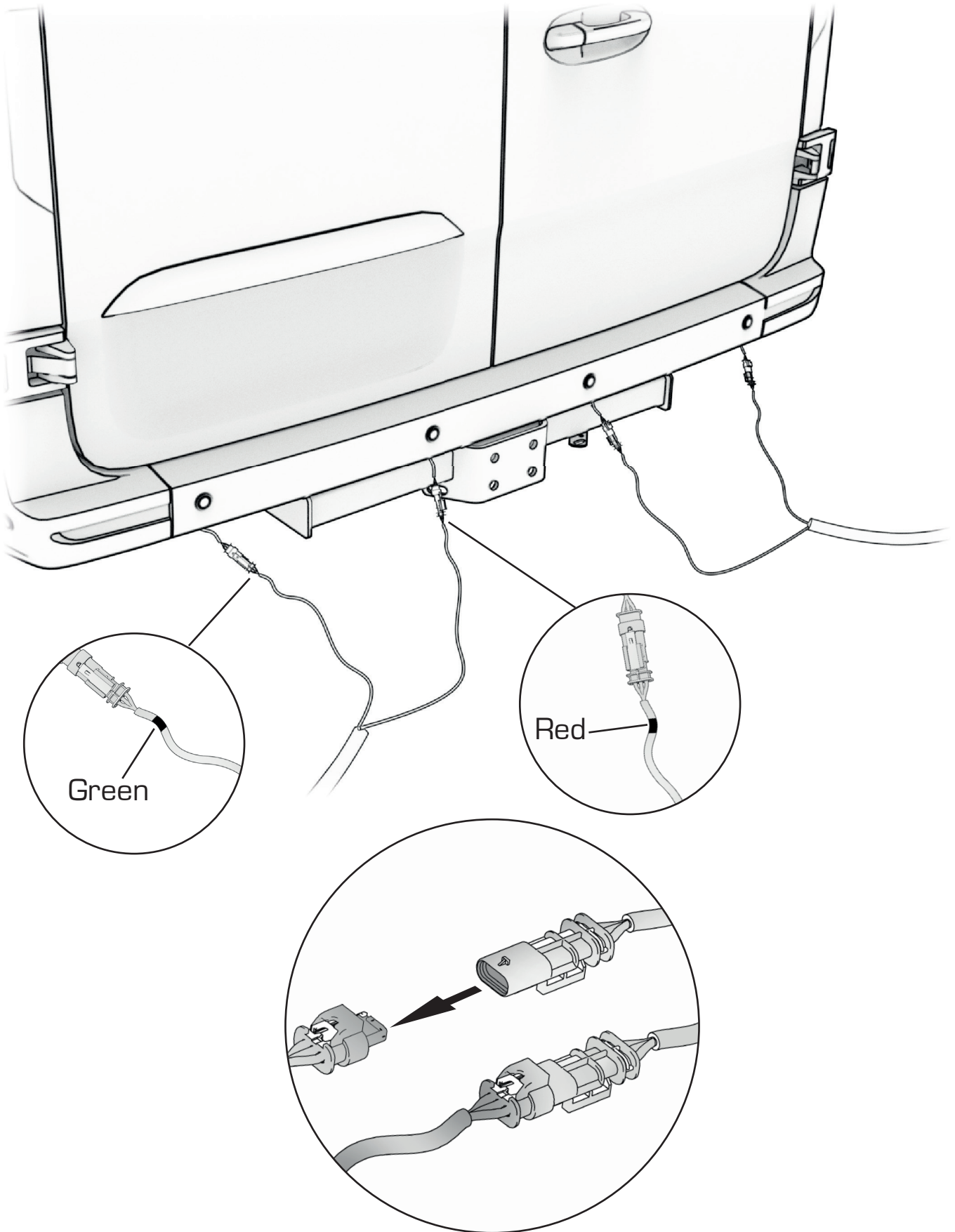



5

Place the connectors back in the bumper

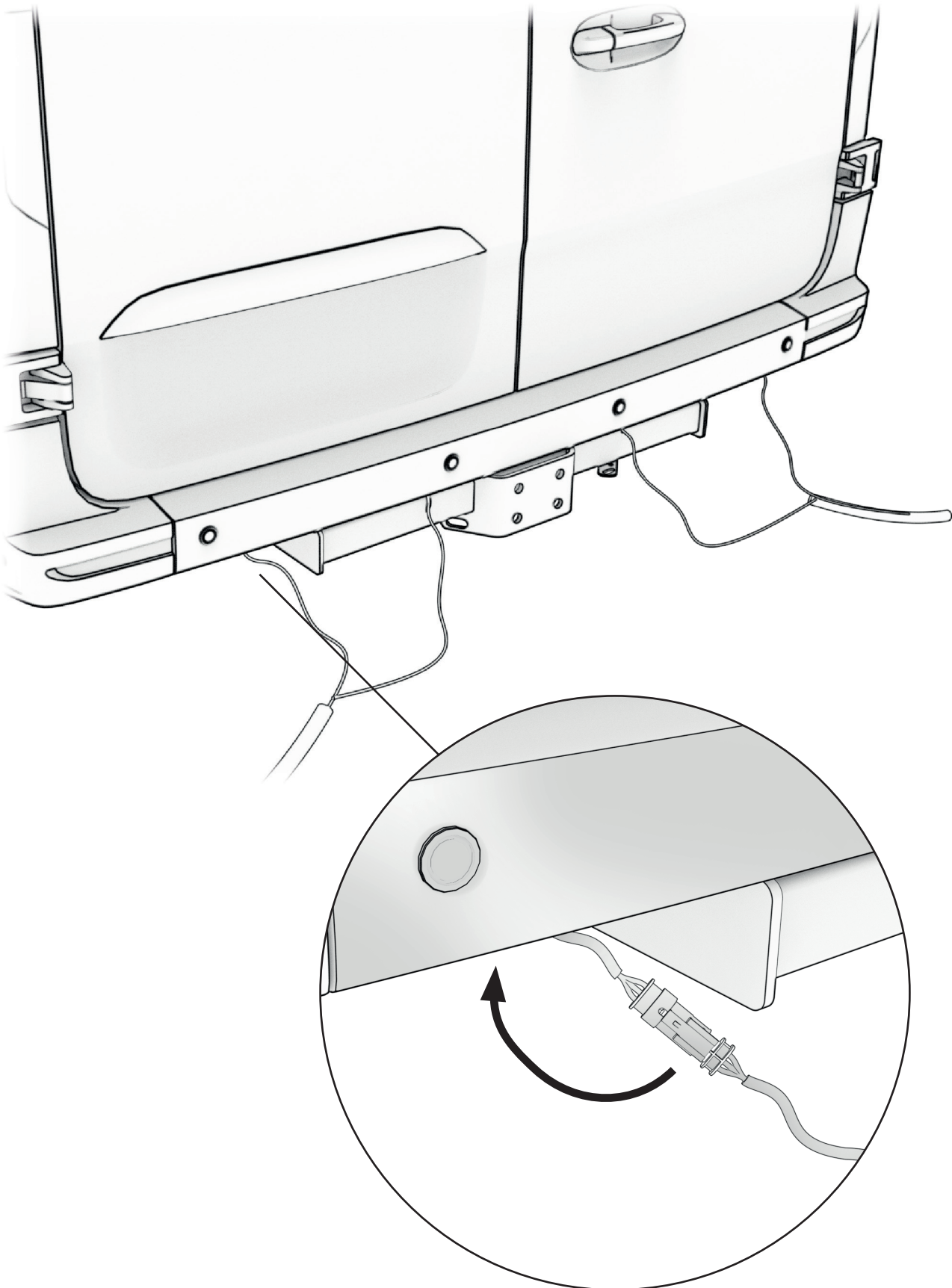

6 Mount the Smart-Step to the towbar

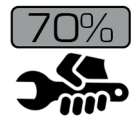
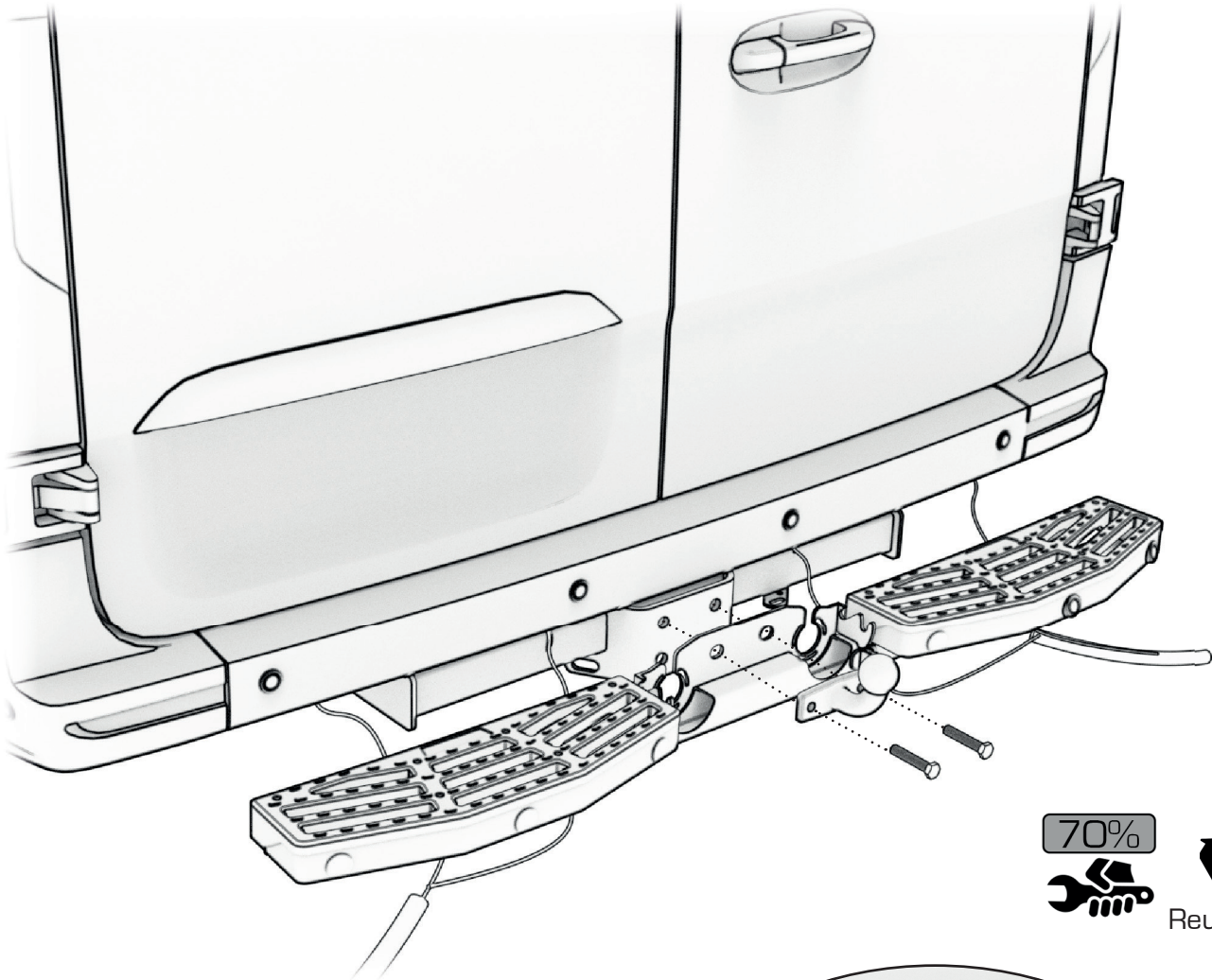

Reuse bolts!

Use the fill-plate for 4 hole towball

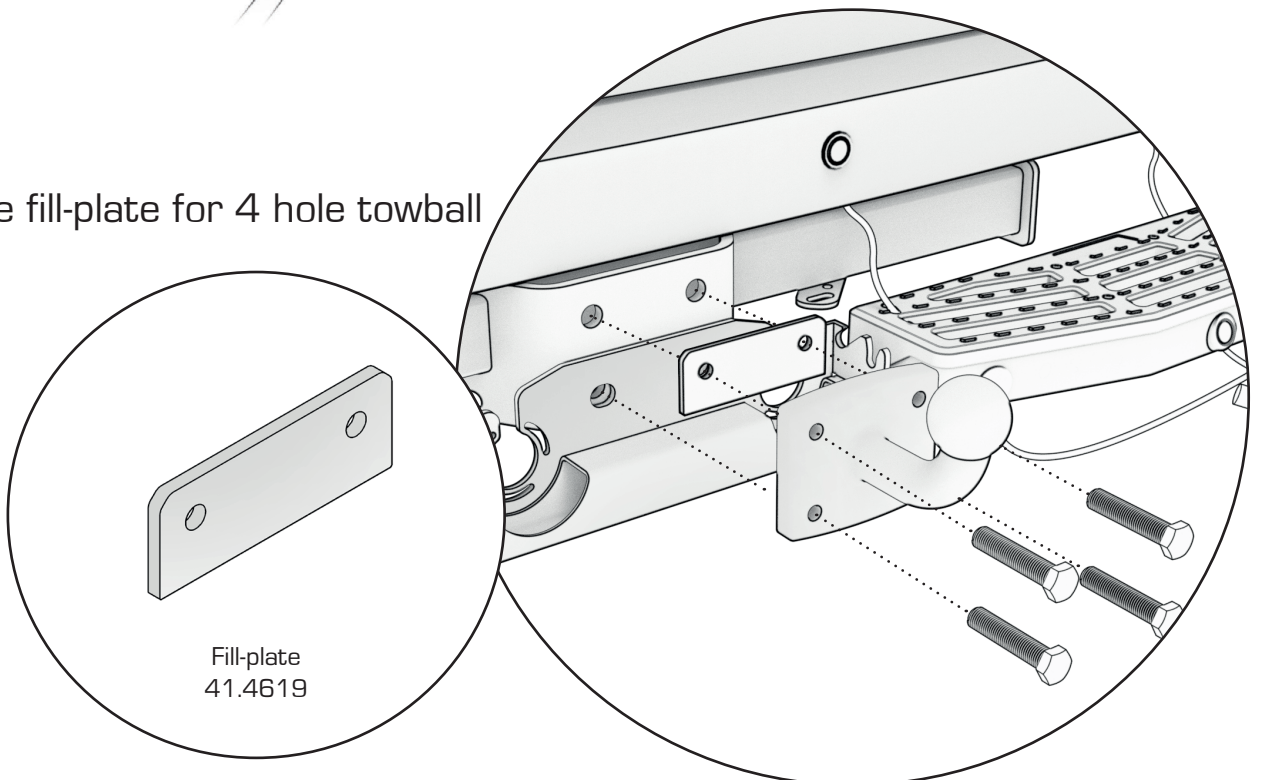

Fill-plate  
41.4619

7

## Mount trailer outlet on the Smart-Step

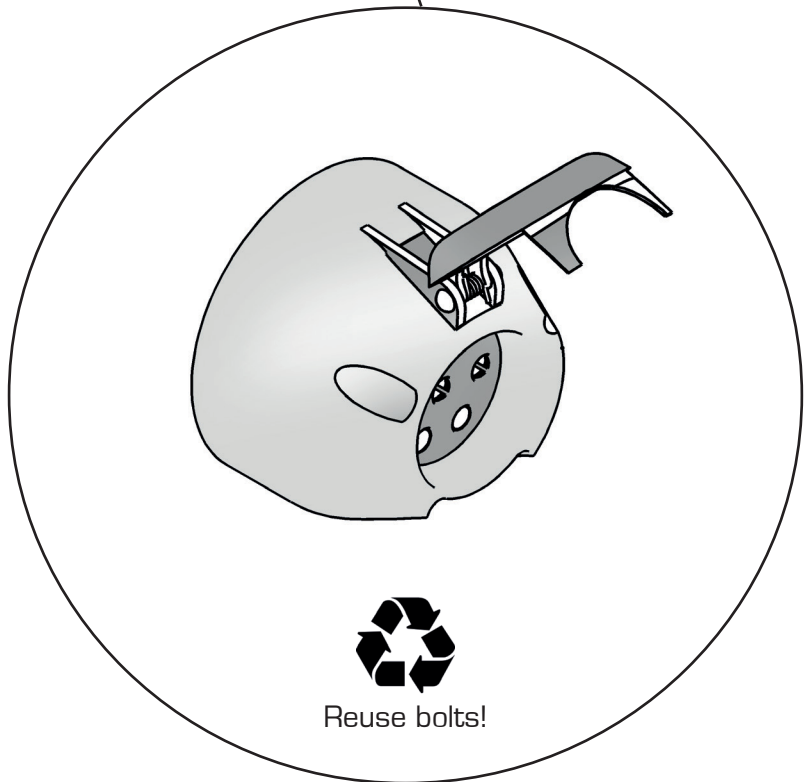
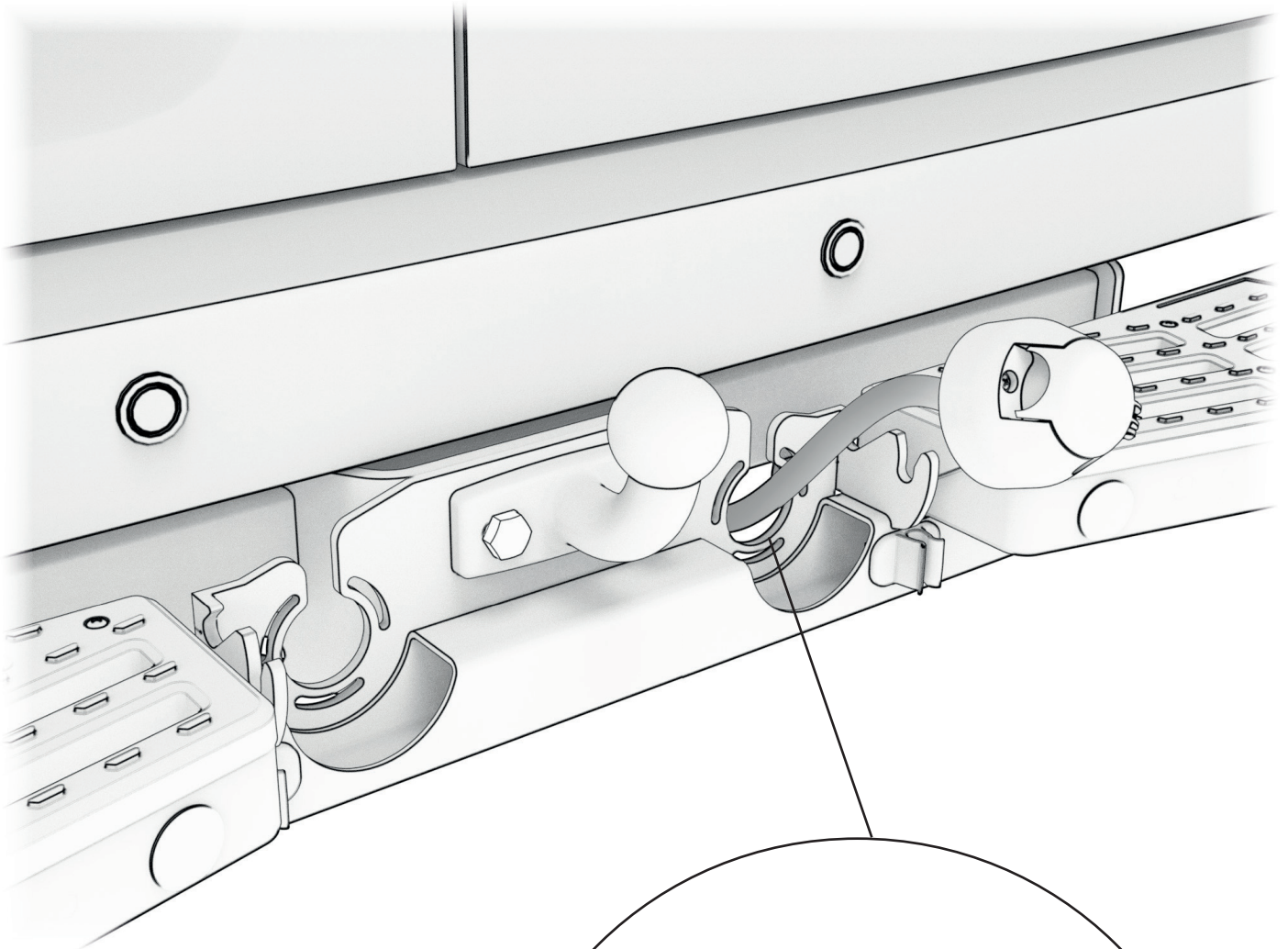



8 Zip tie protection tube to car and Smart-Step

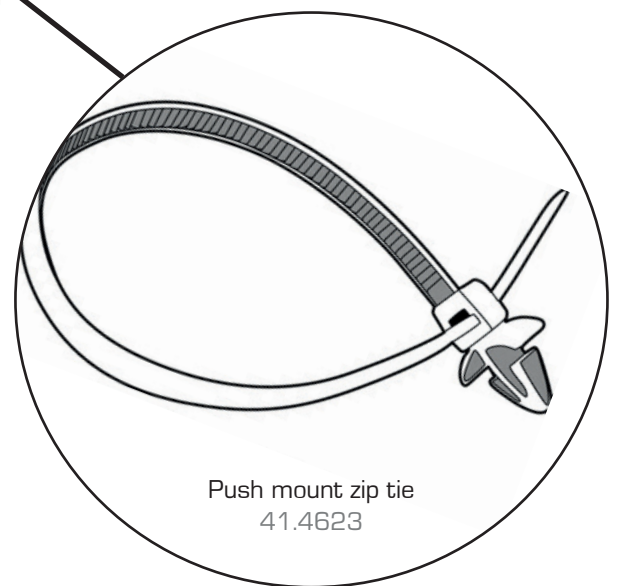
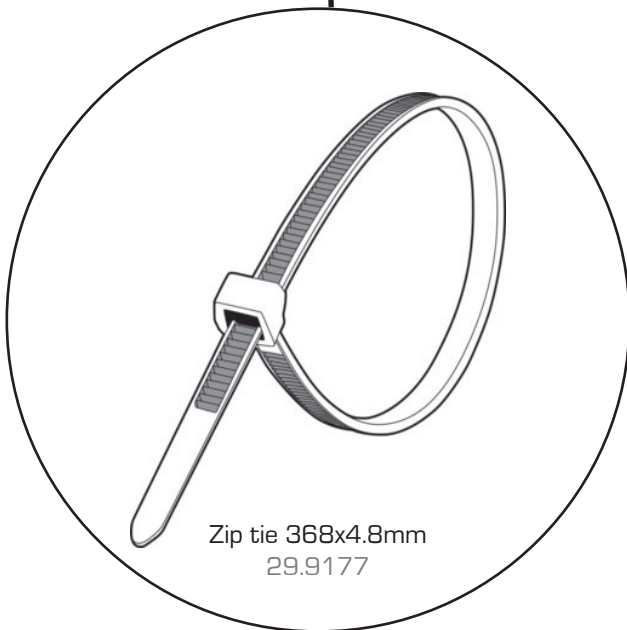
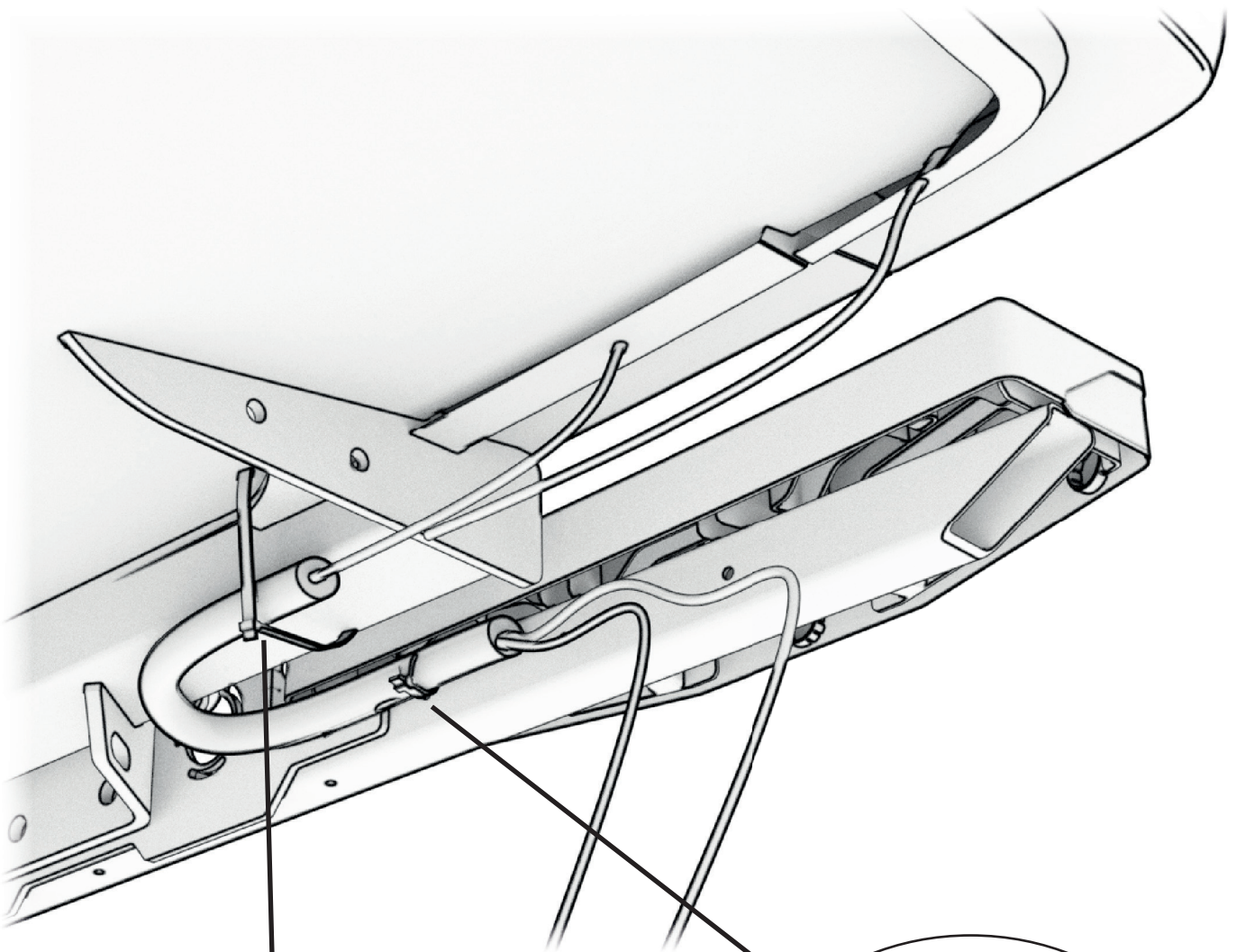

9

Push connectors through back of the Smart-Step

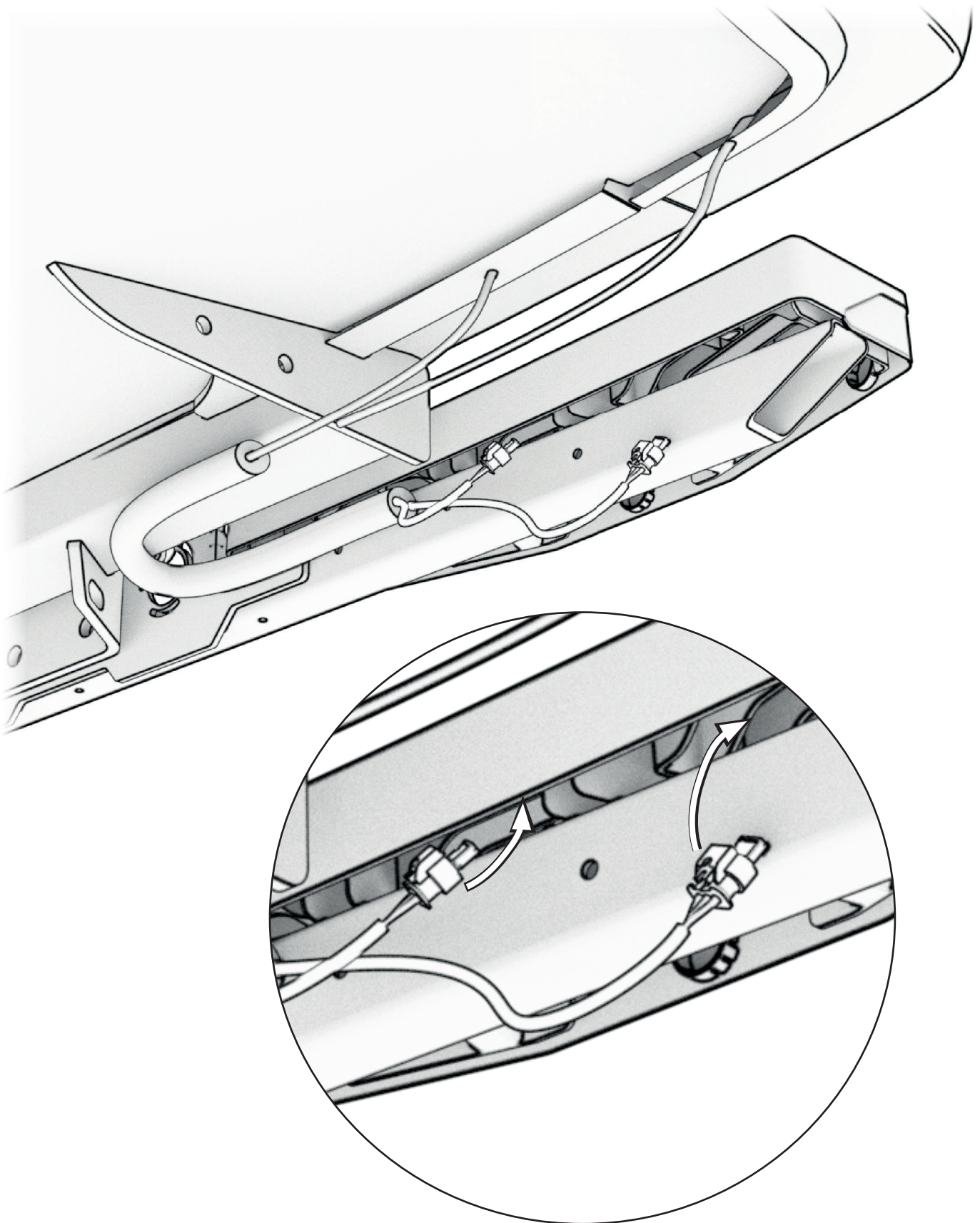



10 Connect sensors to the Smart-Link

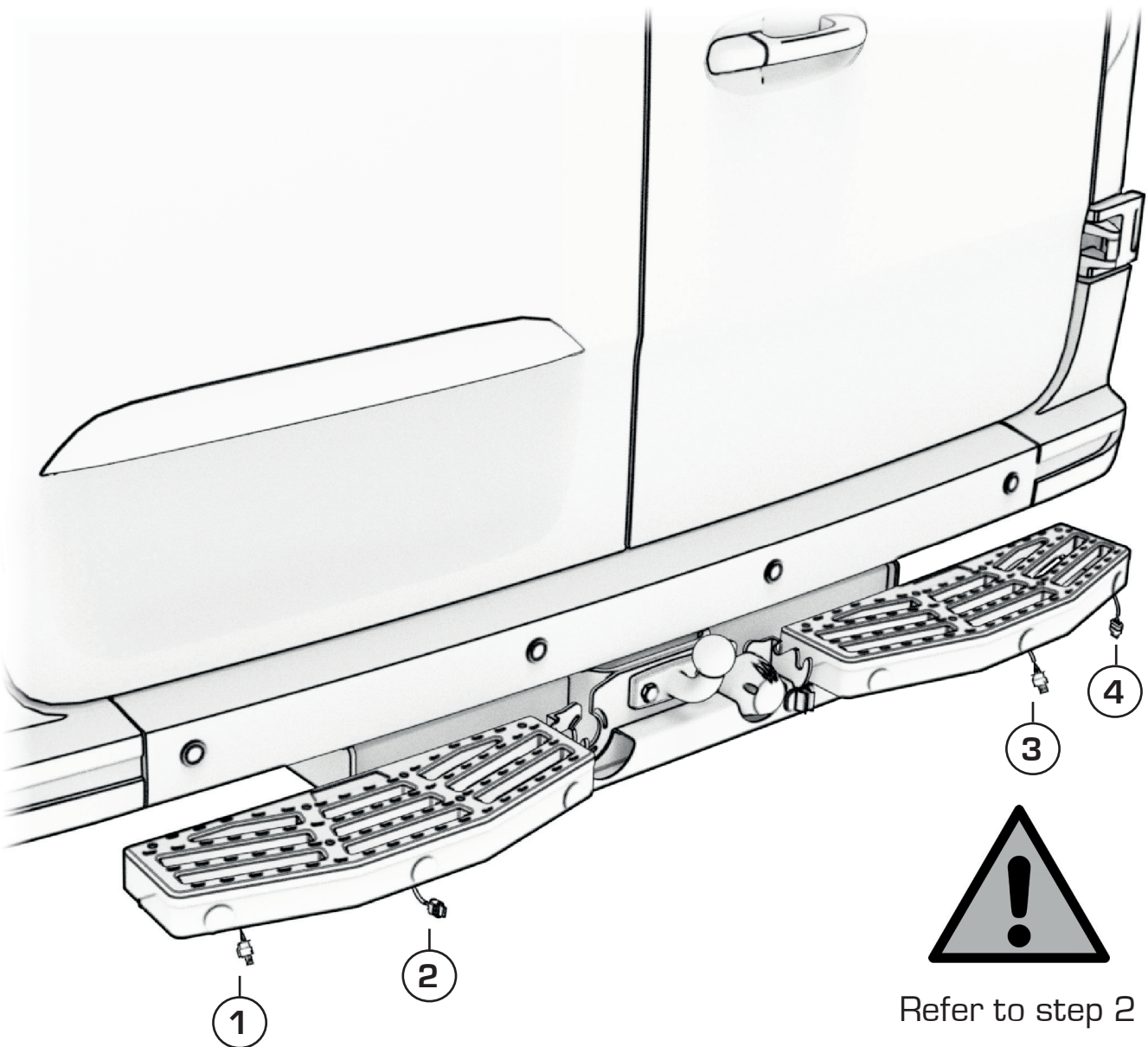
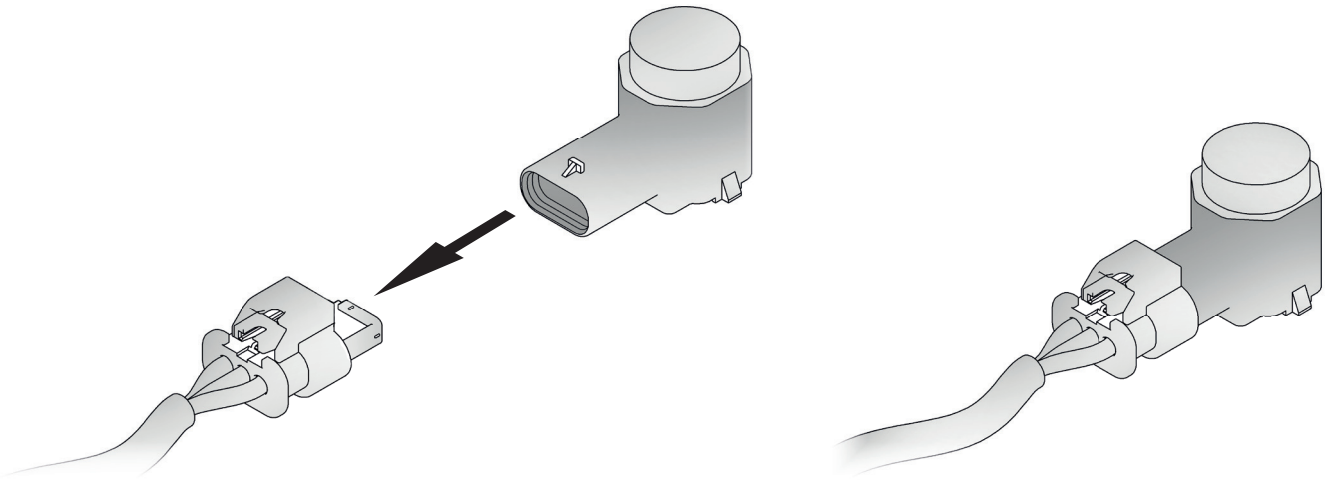

11 Zip tie the wires to the Smart-Step

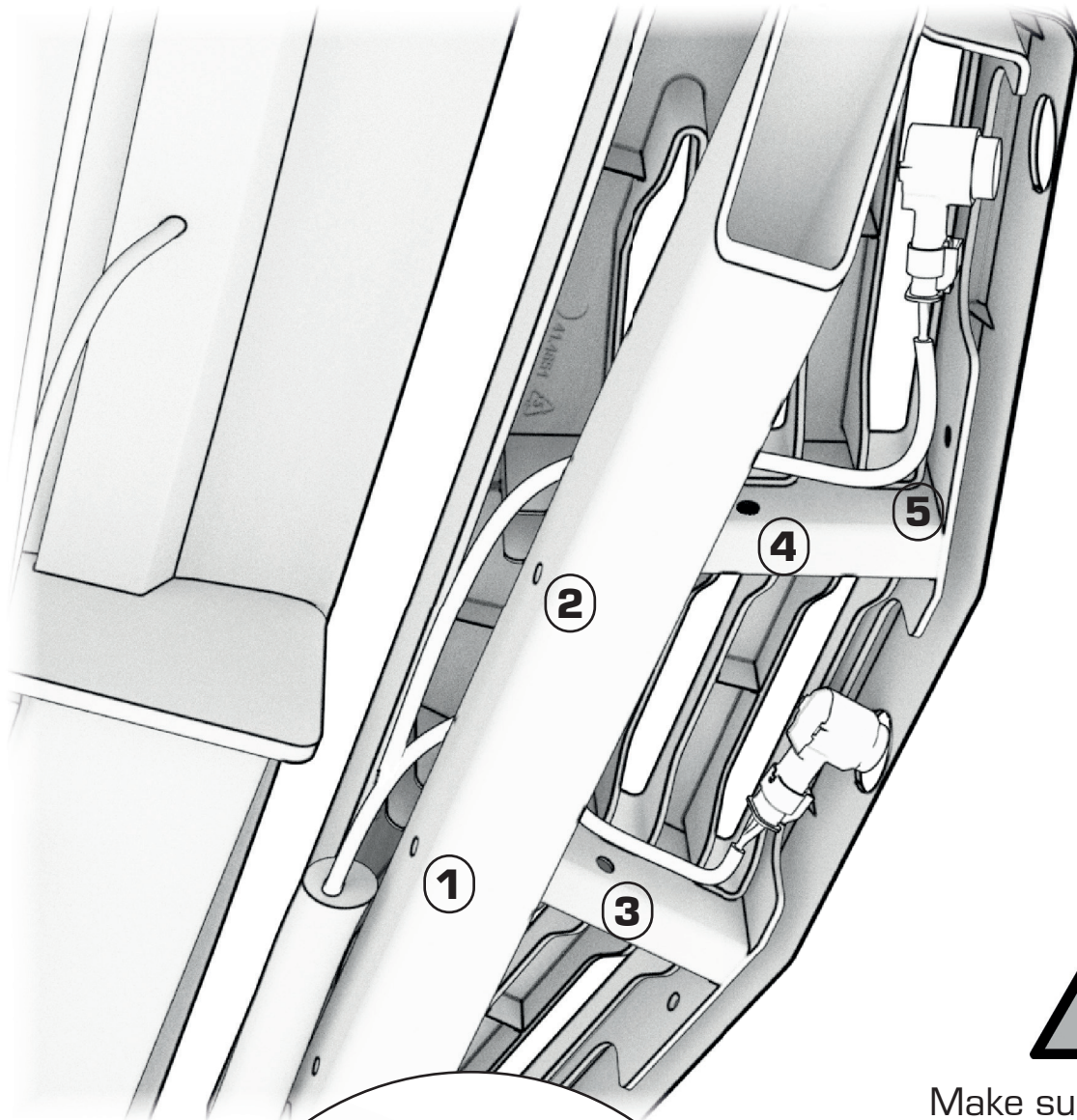

Make sure the sensors line up with the holes

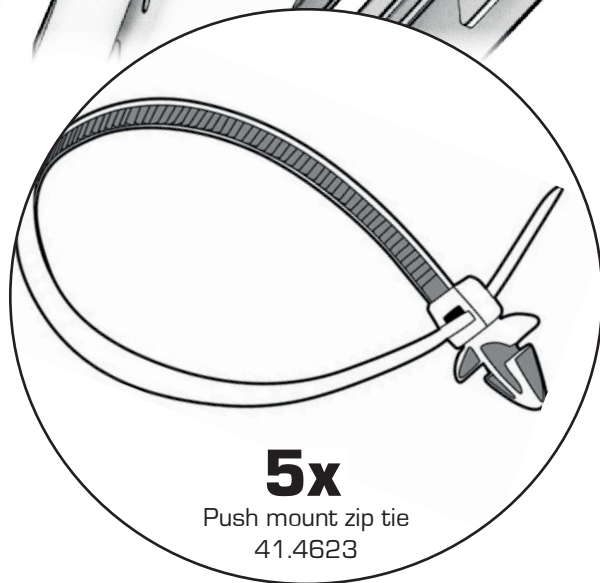



12 Place the PDC Retainer in the Smart-Step

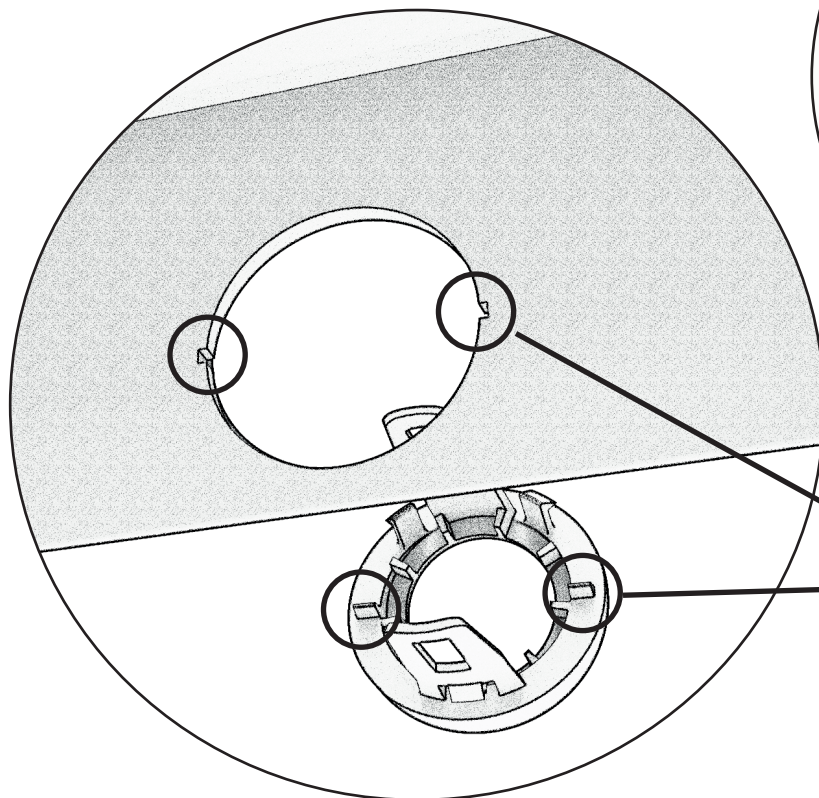
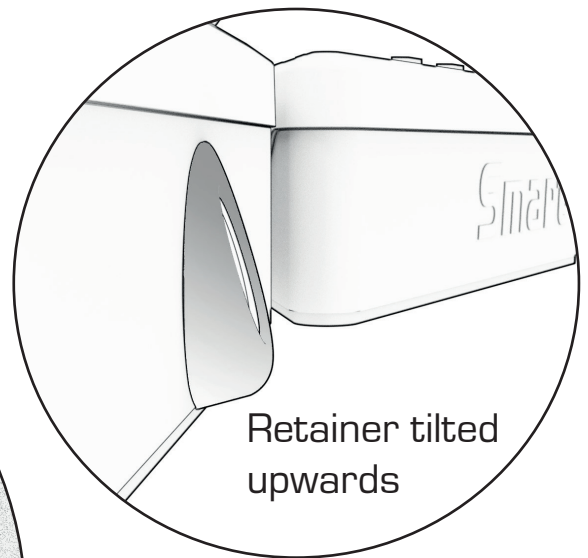
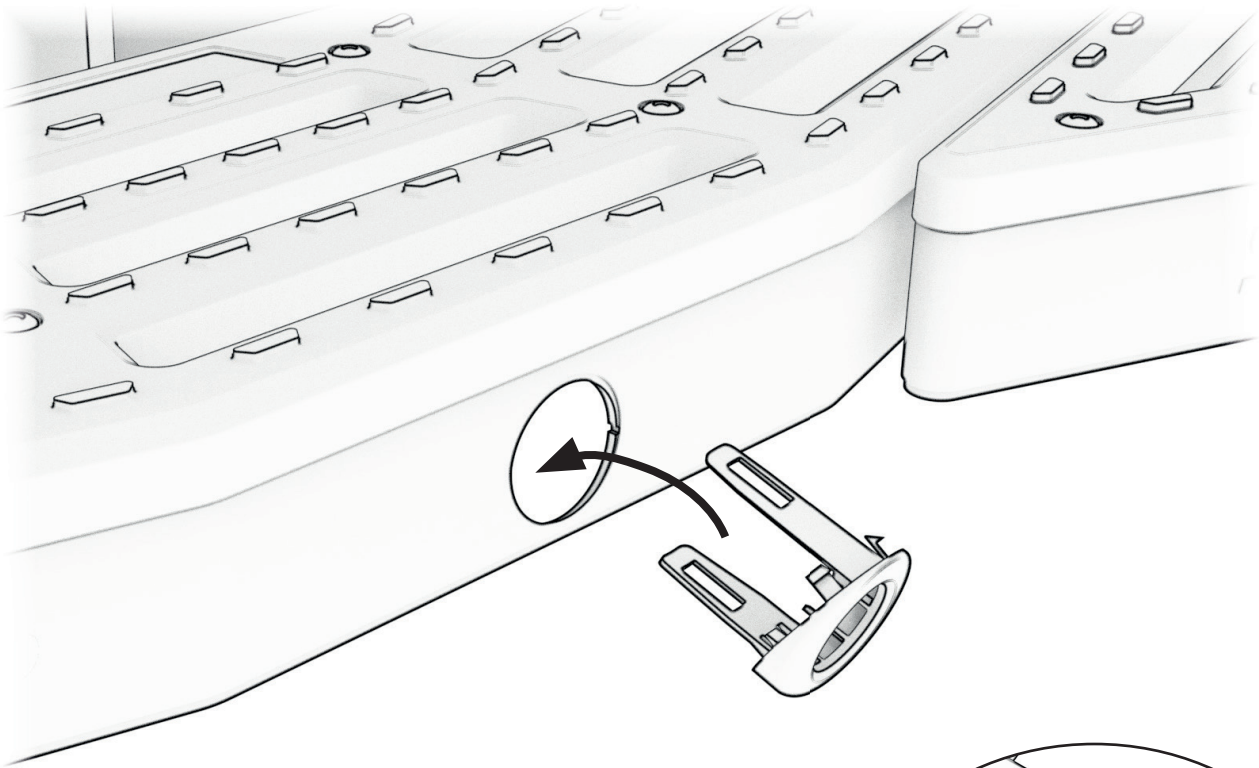

Make sure these line up

13 Place sensor in Retainer and Zip tie

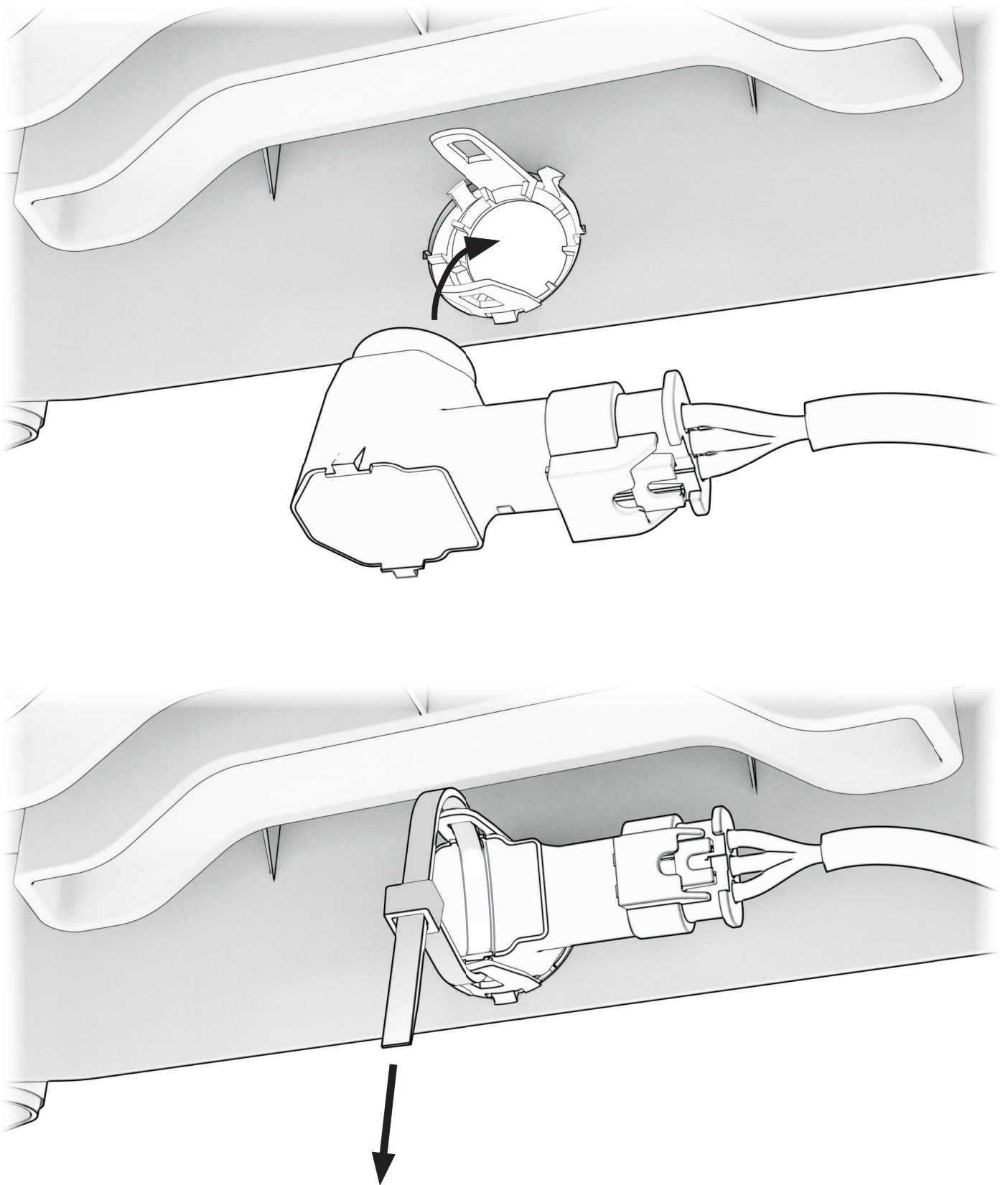



14 Put replacement caps in bumper of the car

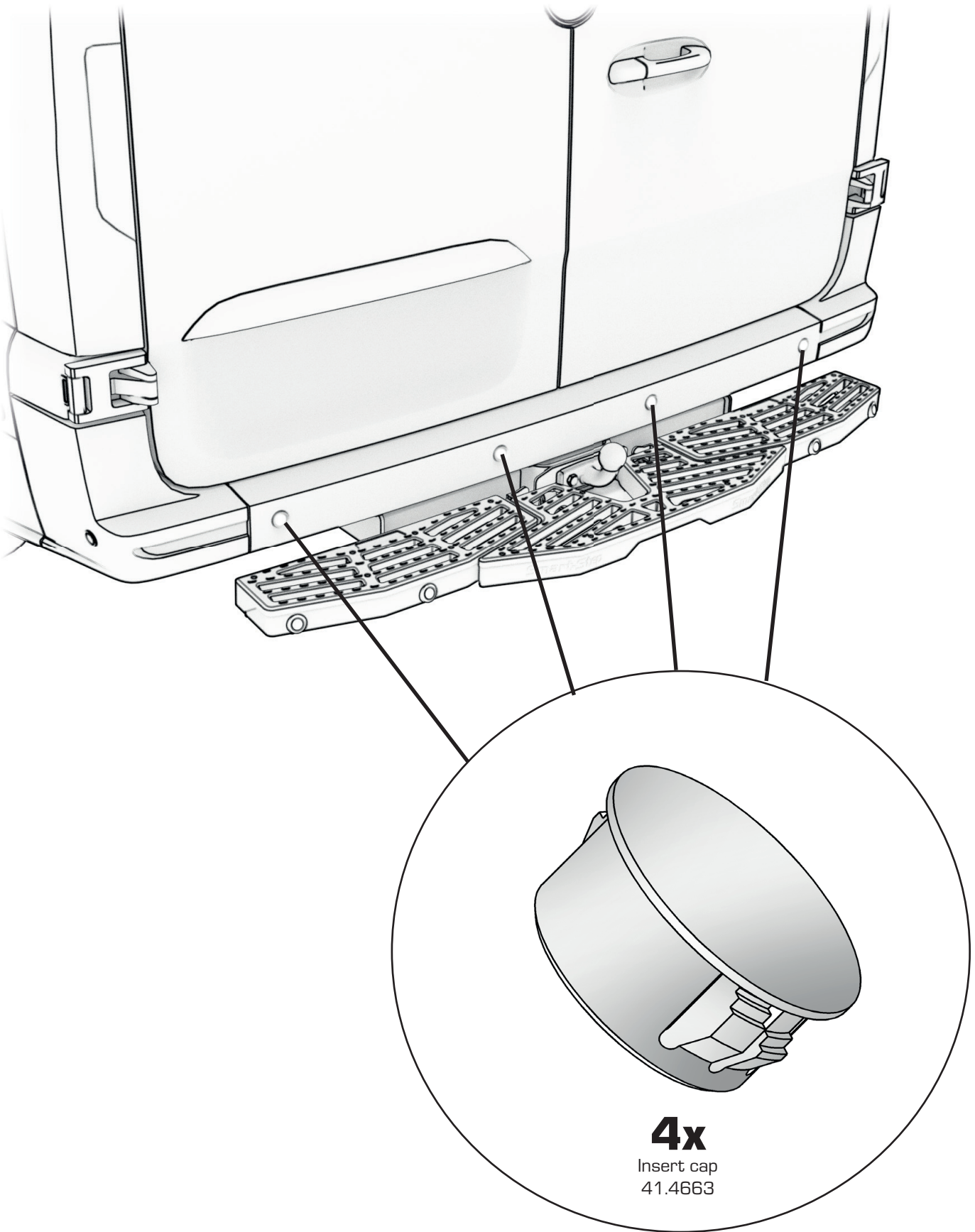



15 Torque the bolts to the specified torque value from the tow-bar

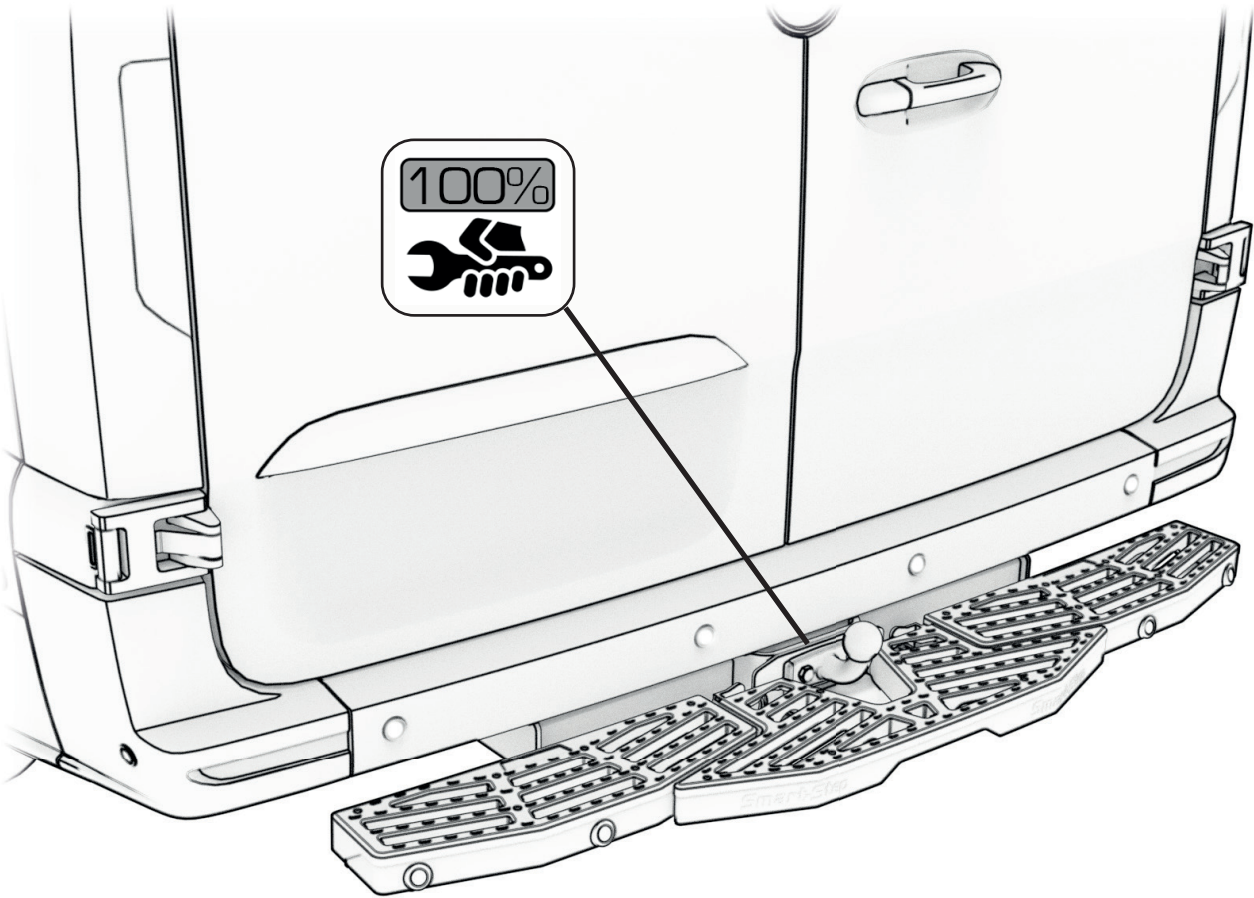

### Locking possibility

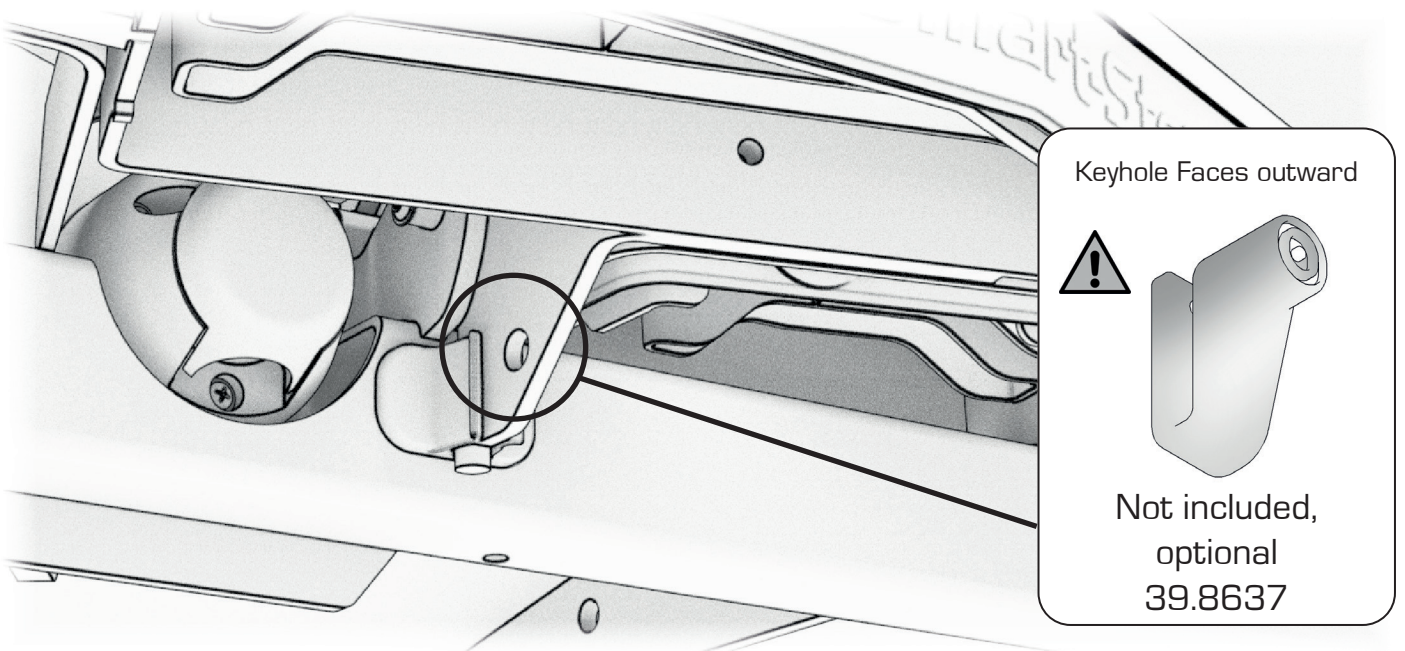



Designed and produced by  
Q-Tech BV, the Netherlands