

## Installation Manual

# CARGOBLOCK

---

The anti-theft for light commercial  
vehicles' rear and side doors



**CARGOBLOCK** Cod.0001070002102



**Citroen Berlingò**



**Peugeot Partner**

## A – INTRODUCTION

The purpose of this Handbook is to provide guidelines for a correct installation of **CargoBlock** on a commercial vehicle. It is advisable to carefully follow all the procedures contained in this manual, essential to correctly install the anti theft device.

**Attention:** information given below are made available by the Services Department and are indicative. They always require a post installation verification.

**StarBlock** disclaims all liabilities for any damage incurred to the vehicle for incorrect installation or for failure to follow Instructions.

## B – GENERAL GUIDELINES

The installation of the CargoBlock has been tested on vehicles by following the installation instructions in the following manual.

Warranty registration of the CargoBlock product is required at [www.starblock.it](http://www.starblock.it)

## C- TECHNICAL FEATURES

It is the anti theft device for the rear and side doors of light commercial vehicles.

Reliable for its light alloy composition. It is made of aluminum with **preformed** and **pre-drilled** stainless steel plates.

Thanks to its design and technology it is practical and easy to install. It is equipped with plates dedicated to the fixing system of each vehicle.

No holes and no changes are made on the doors. The device is installed on the lock studs.

**CargoBlock** is equipped with **StarBlock®** lock with proprietary technology and non duplicable profile key.

Patent n° **202016000071343**.

## D- MAINTENANCE

The maintenance of the product concerns only the periodic cleaning of the lock, through the use of compressed air in the lock hole to eliminate any deposits of dust and lubricating spray.

Maintenance is recommended every six months or more frequently if you work in environments where dust, sand or other similar material are high.

## E- BOX CONTENTS

1. Rear door plate, left side;



2. Rear door fixing plate, right side



3. Side sliding door plate



4. Side door fixing plate



5. Accessory: stud M8X25



## F– INSTALLATION GUIDE

### 1- Rear door, left side

- Unscrew and remove the torx screw securing the lock (**img 1**);
- Tighten the M8X25 stud to prevent the lock from coming loose during installation, then unscrew the other screw (**img 2**);
- Position the rear door plate on the right side in correspondence with the lock fixing holes (**img 3**);
- Fix the plate with the original torx bolt (do not screw in completely for final adjustment of the plate). Unscrew the M8x25 stud and screw in the lock screw.



### 2– Rear door, right side

- Unscrew the two screws securing the hook plate to the vehicle door (**img. 4**);
- Position the plate at the holes in the door. Caution: do not pinch the gasket between the edges of the door and the plate (**img. 5**);
- Fasten the plate with the two torx pins (do not tighten the screws completely for final adjustment of the plate);
- Align the two doors and check that the plates are aligned. Then tighten all screws securely (**img. 6**);

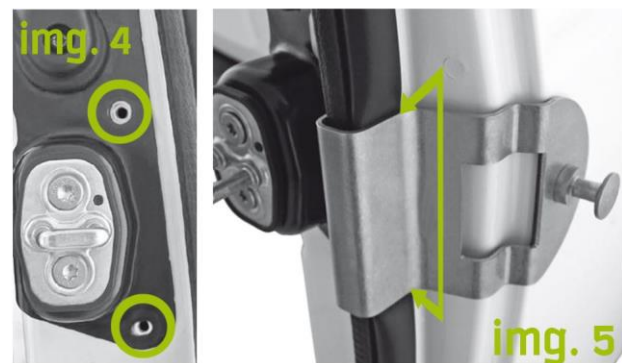

If the lock does not close properly, unscrew the two torx screws on the hook and move it in the direction indicated by the arrow, adjusting it until it closes properly (**img. 7**). Finally tighten all screws.



### 3– Side sliding door plate

- Unscrew the torx screw that fixes the lock and screw in the M8X25 stud to prevent the lock from coming loose during installation, then unscrew the other screw (**img. 8**);
- Position the side sliding door plate at the holes and tighten the torx screw (**img. 9**);
- Unscrew the M8X25 stud and tighten the other screw (do not tighten the screws completely for final adjustment of the plate).



#### 4– Side door fixing plate

- Unscrew the two screws securing the hook on the vehicle door (**img. 10**);
- Position the plate at the holes and simultaneously position the hook on the plate;
- Tighten the two original screws (do not tighten the screws completely for final adjustment of the plate) (**img. 11**);
- Attach the two doors and check that the plates are aligned (**img. 12**). Then tighten all screws.





**StarBlock<sup>®</sup>**

**ST AUTOMOTIVE SRL**  
**Ss 96 Strada Vicinale**  
**Lamarossa snc - 70026 Modugno (BA)**  
**T. +39 080 2143503 - F. +39 080 9692317**  
**[info@starblock.it](mailto:info@starblock.it)**

