

INSTALLATION, USE, AND MAINTENANCE MANUAL

CARGOBLOCK® ND

Protection of Cargo Compartment Doors for Commercial Vehicles

EAN Code: **8056814560645**

Product Code: **0001070002302**

Application:

MAXUS eDeliver 3





Maxus eDeliver 3

A - INTRODUCTION

Objective of the Manual

This manual aims to provide detailed guidelines and essential information for the proper installation of the CargoBlock ND anti-theft system on the vehicle. It is recommended to strictly follow all the procedures outlined, which are essential for ensuring a quick and optimal installation.

Warning

Before proceeding with the installation, it is crucial to verify that the rear and side doors are properly aligned and that the images provided in this manual match those of the vehicle on which the system is to be installed. ST Automotive disclaims any responsibility for damages to the vehicle resulting from incorrect installation or failure to follow the instructions.

B - GENERAL INSTRUCTIONS

Installation of CargoBlock ND

The installation of CargoBlock ND has been rigorously tested on vehicles following the assembly instructions outlined in the attached manual.

Product Warranty Registration

To activate the product warranty, it is mandatory to register on the website: <https://web.starblock.it/garanzia-prodotto/>

C - TECHNICAL CHARACTERISTICS

CargoBlock ND represents the innovative protection for the cargo compartment doors of commercial vehicles, designed for installation without the need for drilling or structural modifications. Made with pre-formed and pre-drilled stainless steel plates, it ensures maximum reliability.

Thanks to its advanced design and cutting-edge technology, CargoBlock ND is practical and simple to install. It comes with dedicated mounting plates for each vehicle model, allowing installation on the original locking points without the need for additional drilling or modifications.

CargoBlock ND is equipped with the proprietary StarBlock® lock, which incorporates advanced technology and a non-duplicable key profile.

D – PACKAGE CONTENTS

- 1 Welcome kit
- 2 Set of reflective stickers for rear and side doors
- 2 Window decals
- 2 Keys + 1 emergency key
- 2 Keychains



Accessories:



1 M6x25 Bolt

Tools required for installation:



Torx key size 30



Torx key size 40



1 - Left rear door plate



2 - Right rear door plate



3- Side sliding door plate



4- Side door pillar plate

E – INSTALLATION GUIDE [Rear Door]



Remove the Torx screw that secures the lock.

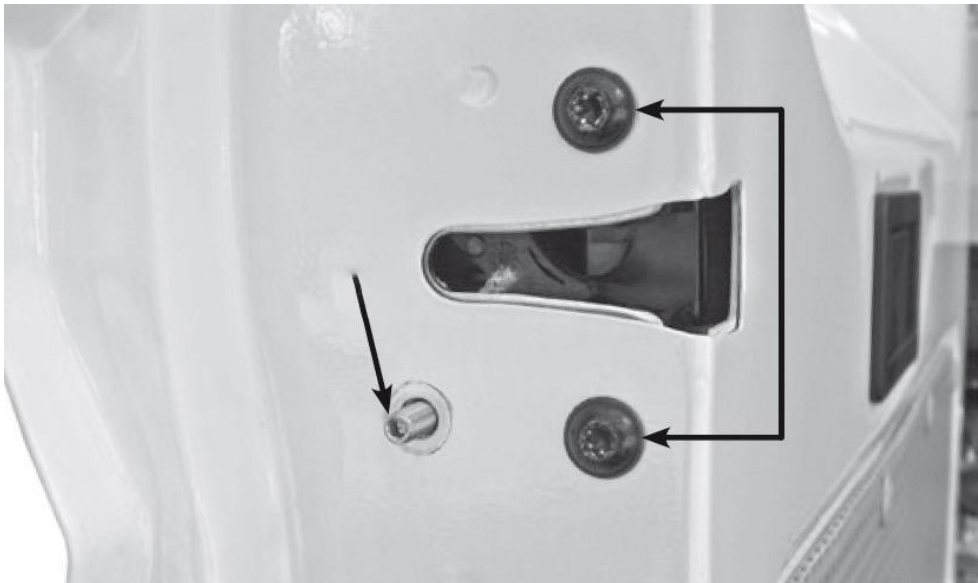

Screw in the supplied bolt to prevent the lock from detaching; then unscrew the two Torx screws that secure the lock.

E – INSTALLATION GUIDE [Rear Door]



Position the plate (as shown in the image) in line with the lock mounting holes.



Secure the plate with the two supplied Torx pins. Remove the bolt and screw in the supplied Torx pin, avoiding tightening the Torx pins completely to allow for the final adjustment of the plate.

E – INSTALLATION GUIDE [Rear Door]



Unscrew the two Torx screws that secure the hook.

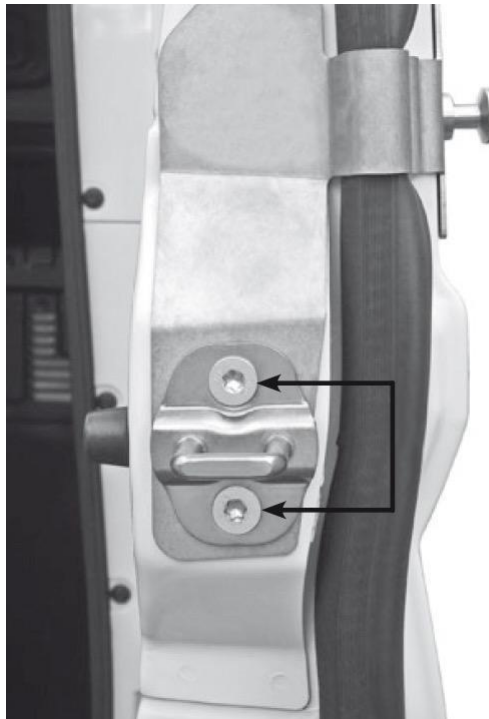

Place the supplied plate in alignment with the hook mounting holes. Position the hook on the plate and secure them with the original Torx pins, avoiding full tightening of the pins to allow for the final adjustment.

E – INSTALLATION GUIDE [Rear Door]



Ensure that during the plate mounting phase, the gasket is not trapped between the edges of the door and the plate.



Bring the two doors together and check that the plates are aligned. Once the alignment is verified, proceed with tightening all the screws.

E – INSTALLATION GUIDE [Rear Door]



Completion of the CargoBlock ND installation on the rear door of the Maxus eD3 vehicle.

E – INSTALLATION GUIDE [Side Door]

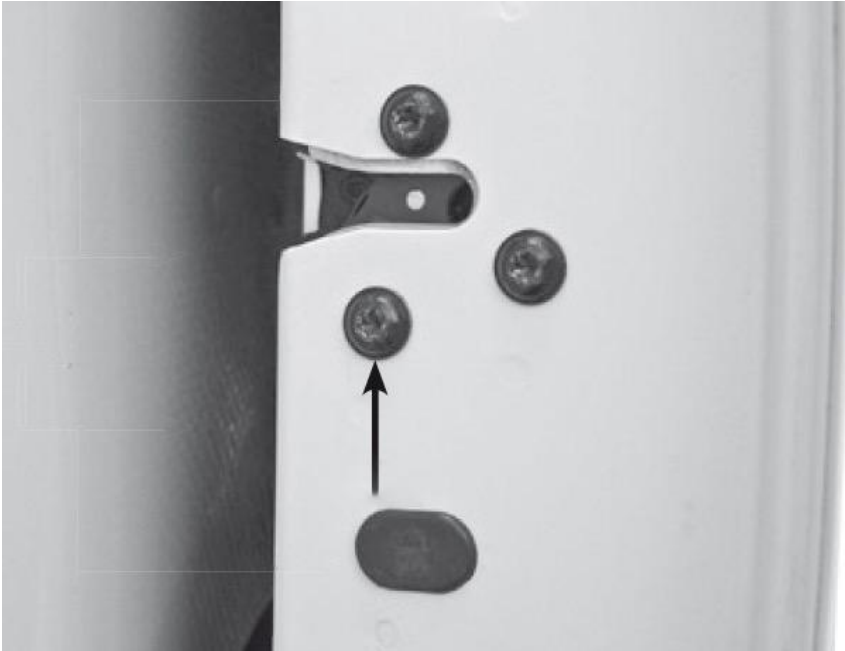

Remove the Torx screw that secures the lock.

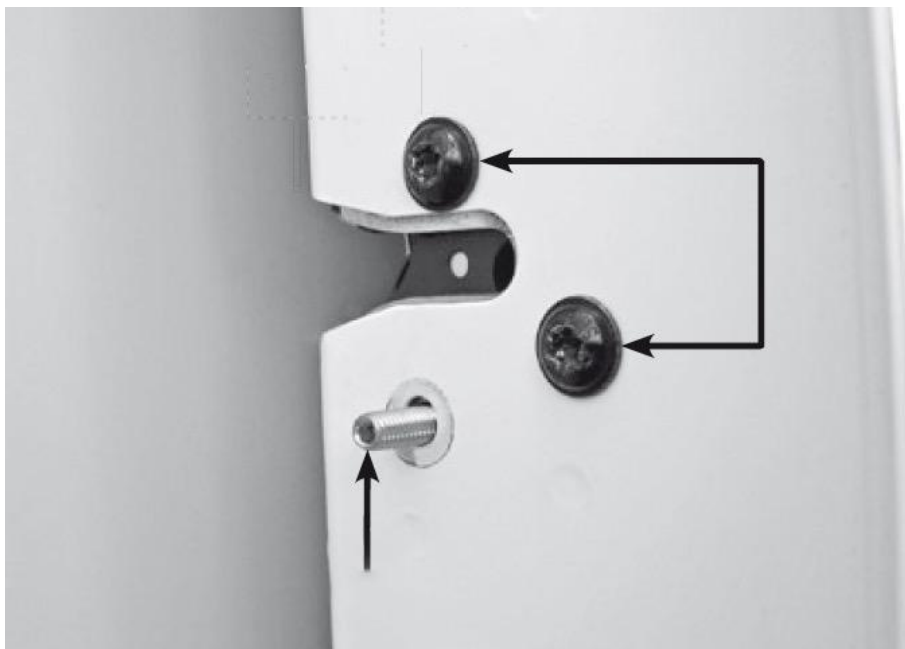

Screw in the supplied bolt to prevent the lock from detaching; then unscrew the two Torx screws that secure the lock.

E – INSTALLATION GUIDE [Side Door]

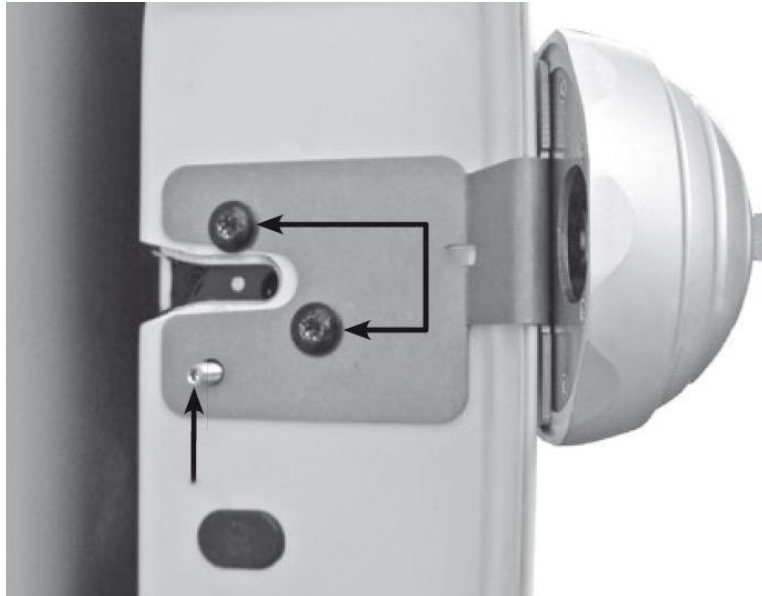

Position the side door plate (as shown in the image) in alignment with the lock mounting holes.



Secure the plate with the two supplied Torx screws. Remove the bolt and screw in the supplied Torx screw; finally, tighten the pins.

E – INSTALLATION GUIDE [Side Door]



Unscrew the two Torx screws that secure the hook.

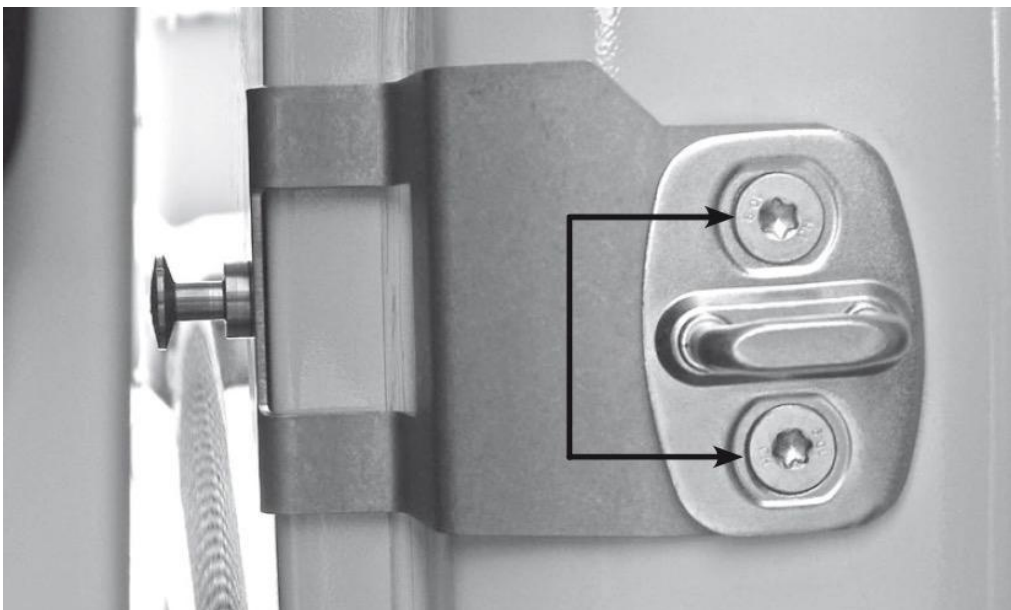

Place the supplied plate in alignment with the hook mounting holes and simultaneously position the hook on the plate. Secure them with the original screws, avoiding tightening them completely to allow for the final adjustment of the plate and hook.

E – INSTALLATION GUIDE [Side Door]

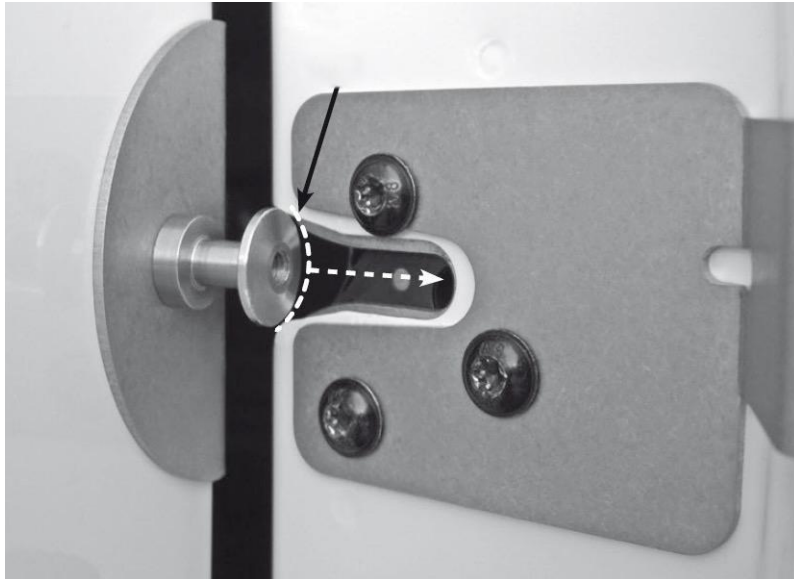

Ensure that the plate's latch is perfectly aligned with the center of the side door lock.



Bring the two doors together and check that the plates are aligned. Once the alignment is verified, proceed with tightening all the Torx screws.

E – INSTALLATION GUIDE [Side Door]



Completion of the CargoBlock ND installation on the side door of the Maxus eD3 vehicle.

F – USE AND MAINTENANCE

HOW TO USE CARGOBLOCK

1. **Opening CargoBlock ND:** Insert the key into the lock of the rear or side doors. Either side of insertion is suitable. Rotate the key 90° clockwise. In this position, the key cannot be removed from the lock.
2. **Closing CargoBlock:** Ensure the vehicle doors are properly closed. Rotate the key counterclockwise. Then, remove the key from the lock.

CARGOBLOCK MAINTENANCE

1. **Periodic Cleaning:** Remove any dust buildup from the product and the lock. Apply a dry lubricant spray to the lock and mechanism.
2. **Maintenance Frequency:** It is recommended to perform maintenance every six months. Perform maintenance more frequently if used in particularly dusty, sandy, or dirty environments.
3. **Additional Protection:** If the vehicle is used on muddy roads, it is advised to use an anti-mud device to protect the lock.



ST Automotive Srl
Ss 96 Km 119
70026 Modugno (BA)
T.+39 080 2143503
info@starblock.it

